

# 20x238 mm striker - round ends

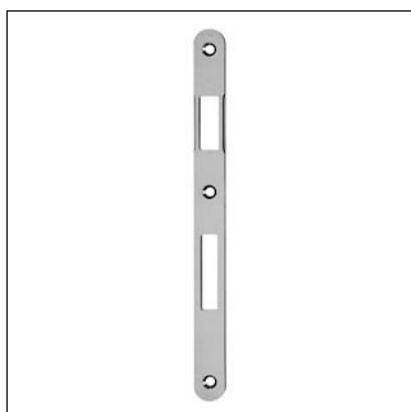

### Description

Steel striker with round ends, 20 mm wide - 238 mm long. The edge is bevelled where the spring latch strikers for easier and smoother closing of the door. Suitable for both right and left-handed applications.

### Application

Used in combination with an 18-mm forend Patent Grande lock, on interior rebated doors with timber frame.

### Mounting

Mill the frame according to the dimensions shown in the diagram. Install the striker flush with the edge of the frame. Fasten with three 4x25 mm screws.

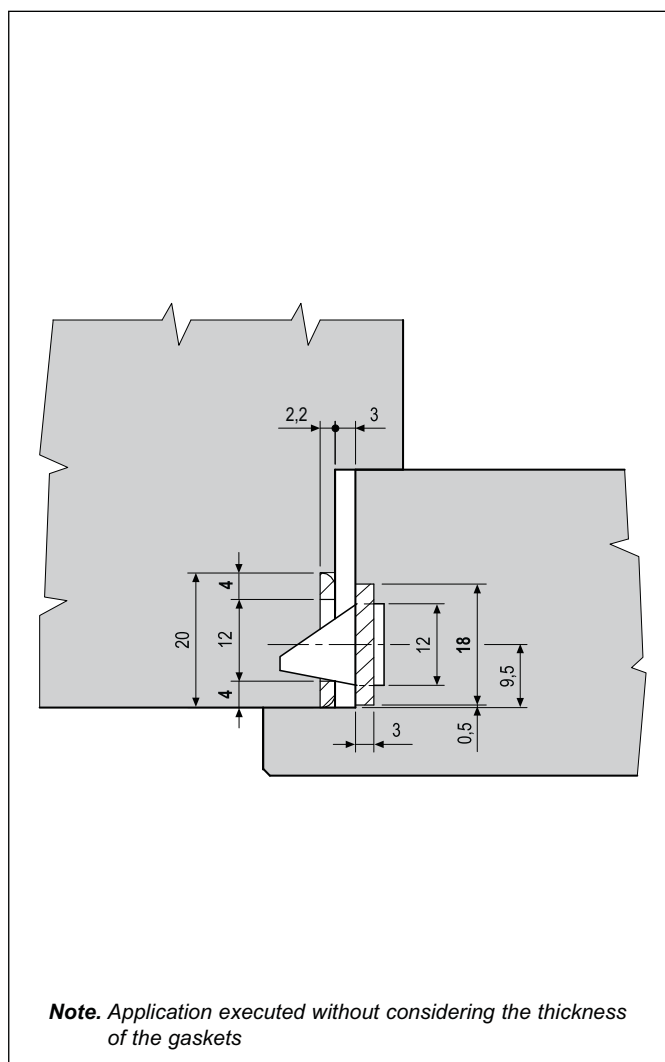
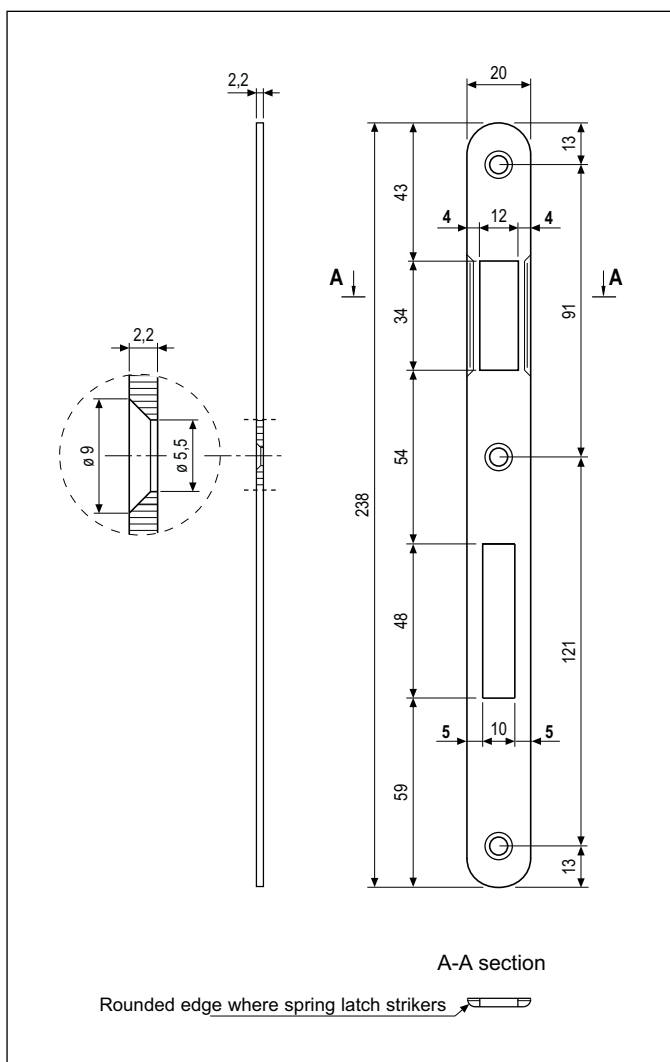

### Order Specifications

Material	SALES CODE		
	Ref.	Model	Finish
STEEL	B00590	42	XX

**Note.** Refer to the price list in force to check the availability of the finishes.